



WELL SECURE



# Well**secure** Oil Tools

**FLOAT**  
EQUIPMENT

STANDING APART IN QUALITY LEADERSHIP



WELL SECURE

[www.wellsecureoiltools.com](http://www.wellsecureoiltools.com)



WELL SECURE

Wellsecure was established in 2019 and since then we have been performing consistently to excel and cater to the demands of our clients. We have been offering our equipments to other well known brand names in India since long, now with the backing of our technical team and Drilling Industry experts we are confident to offer our products in the global market under our own @well secure brand name.

We have received excellent feedback for our products from end users, appreciation and encouragement of drilling team gives us tremendous confidence to scale our operations, we are already getting good response from our global customers. We have attained position of quality leaders in the oilfield equipments and tools Industry by offering innovative and highly standardized quality of casing accessories, centralizers, float Equipment and other downhole tools in a short period of time. Well secure product quality is appreciated by clients which results in repeat orders; in addition to high quality products our technical support helps the end users in making critical decision smoothly and in full confidence. Our fast response and complete technical support increases the confidence of our end users and well secure has earned goodwill and word of mouth publicity enabling us to maintain relationships.

Our manufacturing units at Faridabad near national capital Delhi is within 10 Kms of ICD Tughlakabad which is one of the biggest inland dry ports in Delhi which allows us to deliver products all across the globe in shortest possible time.

Our associates and distributors have offices and well stocked warehouses in South-East Asia, Middle East, CIS and African region and are able to supply these items in shortest possible time.

A PROMISING BEGINNING



WELL SECURE

[www.wellsecureoiltools.com](http://www.wellsecureoiltools.com)



WELL SECURE

### CENTRALIZER PLACEMENT SOFTWARE

Wellsecure Centralizer placement Software calculates the centralizer placement, casing standoff and torque and drag. It analyses and recommends the minimum number of centralizers to define string placement, considering standoff criteria, torque or drag reduction requirements or optimum positioning due to high load areas. The simulations can also accommodate casing floatation and air section length optimization as well as Casing deflection and centralizer compression based on the well data and centralizer performance.

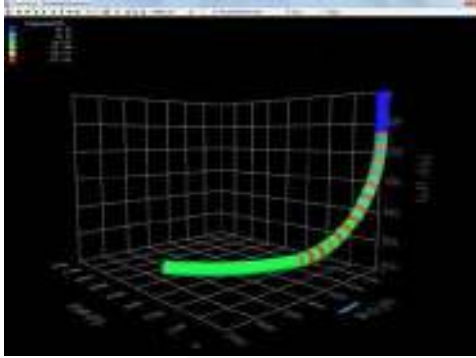

Parameter Visualization

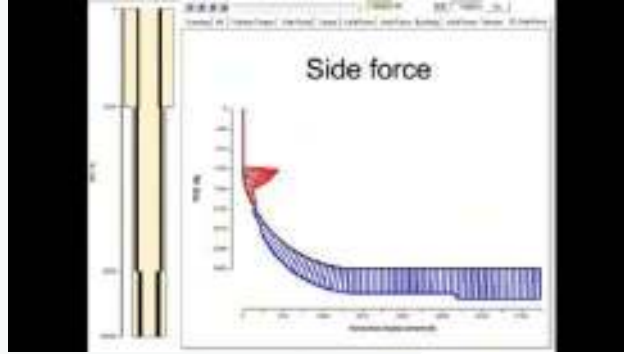

Analysis

Casing centralization is one of the most important step to ensure the quality of a cementing job. It does so by preventing mud channelling and ensuring complete zonal isolation. While centralizers are used extensively, well problems continue to arise due to poor cementing jobs. The challenge that both operators and service companies face is to choose the right type of centralizers for specific well conditions and place the correct amount of them in the optimum position on the casing to achieve a good standoff profile. Well secure Centralizer software optimizes the centralizer placement, predicts casing standoff and torque and drag for ERD or deviated wellbores. It determines the number and placement of centralizers using one of the four modes: "specify spacing", "specify location", "specify standoff" and "optimum" for bow-spring, rigid, semi-rigid, and solid centralizers

TECHNICAL SUPPORT



CERTIFICATE



WELL SECURE



WELL SECURE

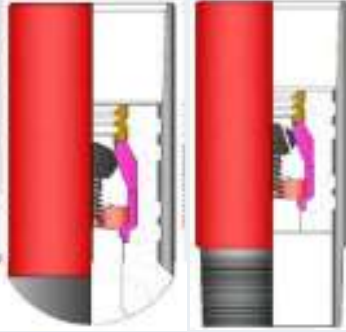

### Single Valve Cement Float Shoe and Collar

Wellsecure Cement Float Shoe and Collar offer dependable performance for all classes of Oil and Gas Wells. The Plunger type valve prevents cement back-flow, provides casing buoyancy during the run-in, and acts as an internal BOP during the process of running and cementing the casing.

This design ensures the valve the maximum circulation rate in vertical, horizontal and deviational wells. The material used for float equipment is seamless casing grade steel. Float equipment can be supplied in all grades of steel. Traceability of component material starts from the mill material certificates; all machining of collars is processed on CNC machines. Float equipment is manufactured to match customer's casing specifications. All Floats shoes and Float Collars are PDC drillable.

#### Performance Features

- Free-floating ball abrades
- Valve parts will not damage PDC bits
- Fast drill-out & No springs
- Operator-controlled buoyancy-regulated by filling casing at surface
- Cost effective

#### Options

- Available in all 3 1/2" to 30" sizes and any special size/configuration as per requirement.
- Available with cement nose, aluminum nose or bladed nose.
- API standard threads are cut in-house as are numerous selected premium threads up to certain sizes. Other premium and custom threading can be supplied and cut through our extensive vendor base.



FLOAT SHOE AND COLLAR SINGLE VALVE



WELL SECURE

[www.wellsecureoiltools.com](http://www.wellsecureoiltools.com)



WELL SECURE

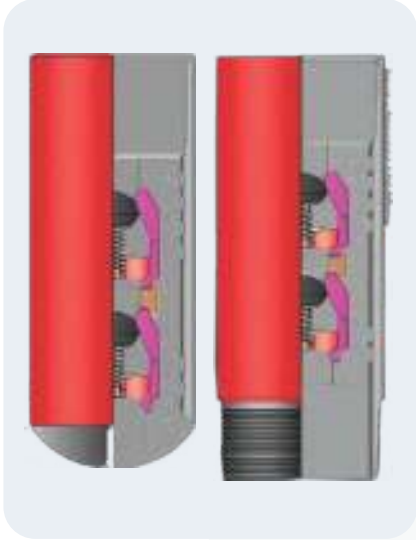

### Double Valve Cement Float Shoe and Collar

Wellsecure Double Valve Cement Float Shoe & Collar Offers dependable performance for all classes of oil and gas wells. The valve prevents cement back-flow, provided casing buoyancy during run-in, and acts as an internal BOP during the process of running and cementing the casing. The Double Valve Float Shoe and Collar acts as an extra back pressure valve sealing against pressure from below when floating in a linear or casing. Float Equipment is manufactured to match customer casing specifications. All Float shoes and collars are PDC Drillable

### Performance Features

- Fast Drill-Out.
- Valve parts will not damage PDC Bits.
- Operator controlled buoyancy regulated by filling casing at surface.
- Double Valve acts an extra back pressure valve.
- Cost Effective

### Options

- Available from sizes 4-1/2" till 36" + any special sizes configurations.
- Available with shoes with cement nose, aluminum nose or bladed nose.
- API standard threads are cut in-house as are numerous selected premium threads up to certain sizes. Other premium and custom threading can be supplied and cut through our extensive vendor base

FLOAT SHOE AND COLLAR DOUBLE VALVE



WELL SECURE

[www.wellsecureoiltools.com](http://www.wellsecureoiltools.com)



WELL SECURE

### Down Jet / Up Jet Cement Float Shoe

Wellsecure Down-jets/Up-jets Cement Float Shoe offers dependable performance for all classes of oil and gas wells. The Plunger Type valves prevent cement backflow, provide casing buoyancy during the run-in, and acts as an internal BOP during the process of running and cementing the casing.

Float equipment is manufactured to match customer casing specifications. All float shoes are PDC drillable. Has the ability to circulate through down-jets/center of the shoe while running in the hole. This provides a means of washing casing/liner to seat if required. Once converted, has the ability for the cement to be pumped through up-jets for optimum cement placement. Ports force circulation flow in a downward jetting action. The Down-jets/Up-jets Cement Float Shoe is also available with Double Valve for extra back pressure, valve sealing against pressure from below when floating in a liner or casing.

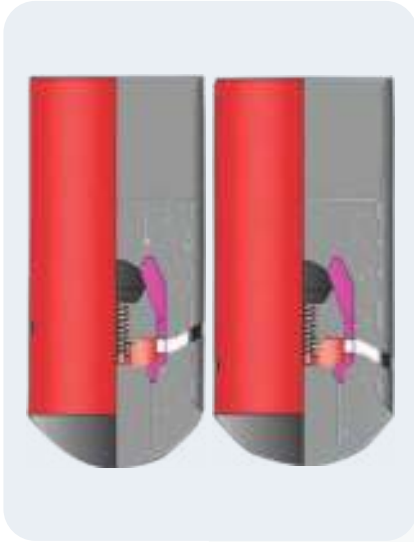

### Performance Features

- Fast drill-out
- Valve parts-will not damage PDC bits.
- Operator-controlled buoyancy-regulated by filling casing at surface.
- Float equipment's are PDC drillable
- Cost effective

### Options

- Available in sizes 9 $\frac{5}{8}$ "- 30" configurations.
- Down Jet / Up Jet cement Float Shoes are also available with Double Valve.
- API standard threads are cut in-house as are numerous selected premium threads up to certain sizes. Other premium and custom threading can be supplied and cut through our extensive vendor base

DOWN JET UP JET CEMENT FLOAT SHOE



WELL SECURE



WELL SECURE

## Stab-In Cement Float Shoe and Collar

Stab-In cementing is an improved method for cementing large diameter casing. -Conventional method require excessive amounts of cement to ensure cement circulation to the surface because of open hole volume, losses to the formation, or mud displacement efficiency that cannot be determined with sufficient accuracy. In addition, large plugs must be used to separate the cement from the mud and have to be drilled out, along with any cement in the casing. With stab-in cementing, the drill pipe is stabbed directly into the Float Shoe or Collar and cement is pumped through the drill pipe until it returns to reach the surface. Cement is then displaced to the bottom of the drill pipe, a wiper dart can be used. The drill pipe is then picked up, circulated, and pulled out of the hole. The Stab-In Float Equipment is used for cementing large diameter casing, lowered on drill pipe. The string presents special cementing consideration due to high displacement volume of large diameter casing. Problems with high displacement are overcome by using Stab-In cementing equipment to allow cementing through drill pipe.



### Performance Features

- Improves displacement accuracy – cement mixing, while pumping continues until cement returns to reach the surface
- Get better cementing quality – reduced cement/mud interface area and high velocity of flow in the drill pipe minimizes cement contamination while the short pumping time eliminates the need for cement retarders
- Reduces cement volume - conventional displacement requires calculation of excess cement factor, whereas with Stab-in methods excess cement needs to be not greater than the volume of the drill pipe. No large plugs are needed.
- Reduces rig time - circulating, pumping, and drill-out time is minimized.
- Protects casing - cementing pressures are confined to the drill pipes in a squeeze job.

### Options

- Available from sizes 9<sup>5</sup>/<sub>8</sub>"- 30".
- Stab-in cement Float Shoes & Collars are also available with Double Valve.
- API standard threads are cut in-house as are numerous selected premium threads up to certain sizes. Other premium and custom threading can be supplied and cut through our extensive vendor base.

STAB IN CEMENT FLOAT SHOE AND COLLAR



WELL SECURE



WELL SECURE

### Duplex Cement Float Shoe and Collar

• Wellsecure Duplex Shoe and Collar are furnished with heavy duty duplex connection. These heavy duty connections have 4" O.D. left-hand threads, 3¼" to 1" bores, and are capable of carrying 100,000 lbs with a minimum safety factor of 2. Special accessories are available for use with large duplex equipment. The Tubing Seal Nipple has field-proven Chevron Seals for positive sealing of the nipple in the seal bore. Duplex Cement Float Shoe and Collar has an expandable left-hand latch mechanism which allows the nipple to be "stabbed" into the duplex connection and when up-strain is applied the latch is expanded to provide full engagement in the duplex assembly. The nipple is released by rotating to the right, unscrewing the latch mechanism of the duplex connection. Left-hand square thread subs with 4" O.D., left-hand threads are also available for use with large duplex equipment.



### Performance Features

- Float collar & shoe is supplied with plunger valve in most of the application.
- Material used for float equipment is seamless casing grade steel.
- Float equipment's are PDC drillable
- Reduces rig time - circulating, pumping, and drill-out time is minimized.
- Protects casing - cementing pressures are confined to the drill pipes in a squeeze job.

### Options

- Available from sizes 9<sup>5</sup>/<sub>8</sub>" - 30"
- Duplex cement Float Shoes & Collars are also available with Double Valve
- API standard threads are cut in-house as are numerous selected premium threads up to certain sizes. Other premium and custom threading can be supplied and cut through our extensive vendor base

DUPLEX CEMENT FLOAT SHOE AND COLLAR



WELL SECURE

[www.wellsecureoiltools.com](http://www.wellsecureoiltools.com)





WELL SECURE

### Butt Weld Cement Float Shoe and Collar

Wellsecure Cement / Plunger – Type Float Equipment's Offers dependable performance for all classes of oil and gas wells. The valves prevent cement backflow, provide casing buoyancy during run-in, and acts as an internal BOP during the process of running and cementing the casing.

Float Equipment is manufactured to match customer's casing specifications. All plunger type cement float shoe & collar are PDC drillable. Butt Weld Casing Collar O.D. matches with the casing O.D. and the upper end is only beveled, not recessed for directly welding on to the casing pipe.

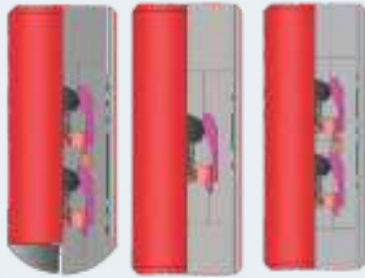

### Performance Features

- Cement/Poppet-type Float equipment offers dependable performance for all classes oil and gas wells.
- The valves prevent cement backflow; provide casing buoyancy during run in.
- Act as internal BOPs during the process of running and cementing the casing.
- Float equipment is manufactured to match customer casing specification.
- All ball type cement float collars are PDC drillable.
- Butt-Weld Casing Collar O.D. matches with the casing O.D. and upper end is only beveled, not recessed for directly welding to the Casing pipe.

### Options

- Available from sizes 5-1/2" to 20" + any special sizes configurations.
- Only Beveled upper end & Directly welding to the casing pipe
- API standard threads are cut in-house as are numerous selected premium threads up to certain sizes. Other premium and custom threading can be supplied and cut through our extensive vendor base.

BUTT WELD CEMENT FLOAT SHOE AND COLLAR



WELL SECURE

[www.wellsecureoiltools.com](http://www.wellsecureoiltools.com)



WELL SECURE



### Slip-On Cement Float Shoe and Collar

Wellsecure Cement / Plunger-type Float equipment offers dependable performance for all classes oil and gas wells. The valves prevent cement back-flow, provide casing buoyancy during run in, and acts as an internal BOP during the process of running and cementing the casing.

Float equipment is manufactured to match customer's casing specifications. All Plunger type cement float shoe & collars are PDC drillable. Slip-On Casing Collar O.D. matches with the casing O.D. and the upper end is only beveled and not recessed for directly welding on to the casing pipe.

### Performance Features

- Fast drill-out
- Valve parts-will not damage PDC bits.
- Operator-controlled buoyancy-regulated by filling casing at surface.
- Float equipment's are PDC drillable
- Cost effective

### Options

- Available from sizes 9<sup>5</sup>/<sub>8</sub>" - 30" sizes configurations.
- Slip-On Float Shoes & Collar are also available with Double Valve.
- API standard threads are cut in-house as are numerous selected premium threads up to certain sizes. Other premium and custom threading can be supplied and cut through our extensive vendor base.

SLIP ON CEMENT FLOAT SHOE AND COLLAR



WELL SECURE

[www.wellsecureoiltools.com](http://www.wellsecureoiltools.com)



WELL SECURE



### **Auto Fill Cement Float Shoe & Collar**

Wellsecure Auto Fill Cement Float Shoe & Collar permits the casing to fill automatically while being run in the hole. The valve is always in the open position allowing maximum filling of the casing as it is lowered into the well bore. The circulation may be established at any time during or after casing is run. The flapper type back pressure valve does not become operative until the drop ball is dropped or pumped down. Like differential fill-up equipment, the shoe is activated by the same ball. From this point on, like differential fill-up shoe, this model Auto Fill Cement Float Shoe acts as conventional floating equipment. All Auto Fill Cement Float Shoes & Collar are PDC drillable. This is especially effective on liner job and sensitive hole conditions.

### **Performance Features**

- Flapper type valve that is installed in short 8 round API casing couplings in shallow well applications
- Auto fill-up/pump-out sleeves are available to convert into an automatic fill-up unit.
- Manufactured to withstand various differential pressures.
- Float equipment's are PDC drillable
- Cost effective

### **Options**

- Available in sizes 9<sup>5</sup>/<sub>8</sub>"- 30"
- Non-Rotating Auto Fill Float Collar also available as per customer requirement.
- Auto Fill Float Shoes & Collars are also available with double valve.
- API standard threads are cut in-house. Other premium and custom threading can be supplied and cut through our extensive vendor base.

**AUTO FILL CEMENT FLOAT SHOEC AND COLLAR**



WELL SECURE



WELL SECURE

### Non-Rotational Cement Float Collar

Wellsecure Cement/Plunger-type float equipment offers dependable performance for all classes of oil and gas wells. The valves prevent cement backflow, provide casing buoyancy during run-in, and act as an internal BOP during the process of running and cementing the casing.

Float equipment is manufactured to match customer's casing specifications. All plunger type Cement Float Collars are PDC drillable. Float Collar is Non-Rotational type pressure and cementing plug activated. The latch down type anti-rotational feature of the plug which is compatible with the Float Collar eliminates rotation during drilling. The Cement Float Collar is also available with double valve for extra back pressure valve sealing against pressure from below when floating in a liner or casing.



### Performance Features

- Operator-controlled buoyancy-regulated by filling casing at surface.
- Manufactured to withstand various differential pressures.
- Float equipment's are PDC drillable
- Cost effective

### Options

- Available in sizes 9<sup>5</sup>/<sub>8</sub>"- 30"
- Non-Rotational Float Collars are also available with double valve
- API standard threads are cut in-house. Other premium and custom threading can be supplied and cut through our extensive vendor base.

NON ROTATIONAL CEMENT FLOAT COLLAR



WELL SECURE

[www.wellsecureoiltools.com](http://www.wellsecureoiltools.com)



WELL SECURE

## Reamer Shoes

Wellsecure Reamer Shoe is designed for demanding downhole applications and is ideal for well bore condition with severe doglegs, high build rates, and extended horizontal runs. The selection of Float Shoes accompanied with a variety of aluminium eccentric noses offer downhole solutions when dealing with well-bore conditions that involve ledges or sloughing.

This Float Shoe is specifically designed for reaming and reciprocating applications. Various styles of noses are offered: Bullet, Eccentric, Spade and Cone. The valves prevent cement back-flow, provide casing buoyancy during the run in, and acts as an internal BOP during the process of running and cementing the casing.

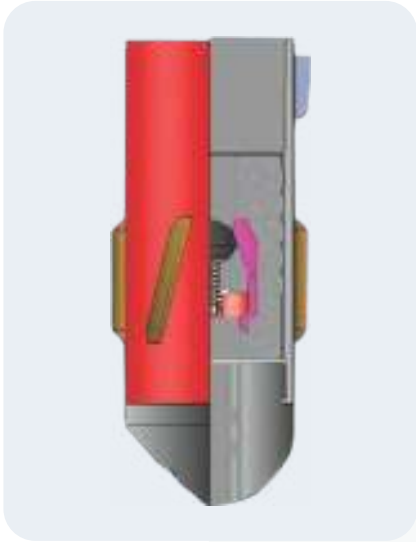

## Performance Features

- Equipped with a Cut-Rite carbide cutting material structure to help eliminate any obstructions and to keep from having to pull the casing to make another wiper run by assuring near gauge hole when running casing.
- A tapered composite nose is standard with high-port up jet and down-jet nose options to help Jet away filter cake and low side debris in horizontal and deviated well-bores.
- For use with and without rotation.
- Specially built to fit any casing and hole size combinations.
- Reamer shoes are equipped with a standard enclosed down-jet nose with an aggressive cutting structure.
- PDC drillable
- Compatible with all casing and liner hanger assemblies. Supplied in casing grade as per requirement

## Options

- Available in sizes 9<sup>5</sup>/<sub>8</sub>"- 30" or other special combinations as per requirements.
- Reamer Cement Float Shoes are also available with Double Valve
- API standard threads are cut in-house. Other premium and custom threading can be supplied and cut through our extensive vendor base

REAMER SHOES



WELL SECURE



WELL SECURE

### Guide Shoe

Wellsecure Guide Shoes are attached to the lowermost end of the casing string to provide a low-cost method of enabling the casing to pass ledges or obstructions in the well-bore, which aids bit re-entry. The cement guide shoe may be used in combination with any type of collar. It efficiently guides casing past sidewall irregularities. It has the ability to circulate through down-jets/centre of the shoe while running in the hole. This provides a means of washing casing/liner to seat if required.

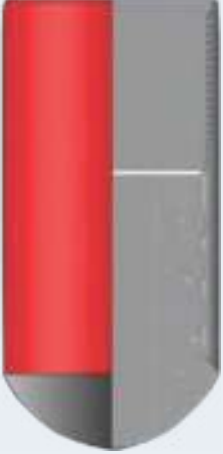

### Performance Features

- Orifice is sufficiently large as to allow tripping balls, tubes and debris to exit the casing without obstruction
- Rounded nose assists while running casing in hole
- Load bearing capability for setting at bottom
- PDC drillable

### Options

- Available in sizes 4 1/2" - 30"
- API standard threads are cut in-house. Other premium and custom threading can be supplied and cut through our extensive vendor base

GUIDE SHOES



WELL SECURE



WELL SECURE

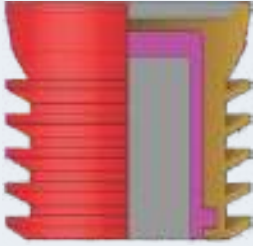

### Conventional Plug

Wellsecure Conventional Top and Bottom Cementing Plug significantly reduce the drill out time, thereby resulting in cost saving. The Bottom Plug separates the cement from drill mud and features a rubber diaphragm which is opened once the plug has landed and latched into the Conventional Float Collar.

The top plug is used as a follow-up plug to displace cement, latches into the upper end of the bottom plug after latching these provide an anti-rotational feature to eliminate rotation during drilling and save drill out time.

### Performance Features

- The Top & Bottom Plug are constructed of material selected to reduce the drill out time, there-by resulting in cost saving.
- The Top Plug is used as a follow plug to displace the cement and land on the upper end of the Bottom Plug.
- The body consists of ebonite insert molded with elastomer. This allows the drill bit to fracture the ebonite rather than tear the rubber and aluminium as with a conventional Plug thus reducing the drill out time significantly.
- No metal parts are used therefore the Plugs are PDC drillable.

### Options

- The Conventional Cementing plugs are available in sizes 4 1/2" to 20".
- Options available in Conventional Top Cementing Plug & Conventional Bottom Cementing Plug as per requirement. Plug is also available and can be drilled out with PDC and conventional drill bit
- Wellsecure Conventional Cementing plugs are available in NR, SBR, NBR and HNBR grades.

CEMENT PLUGS



WELL SECURE



WELL SECURE

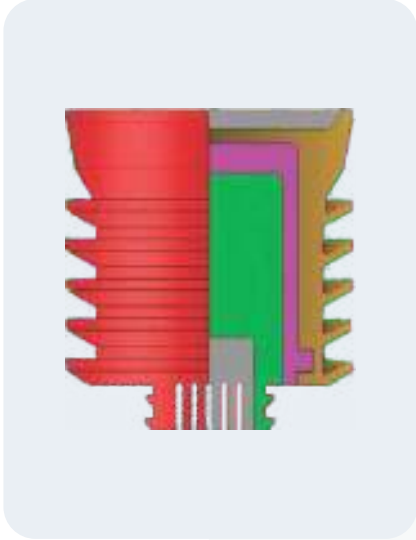

### Non-Rotational Plug

Wellsecure Non-Rotating Top and Bottom Cementing Plug significantly reduce the drill out time thereby resulting in cost saving. The Bottom Plug separates the cement from drill mud and features a rubber diaphragm which is opened once the plug has landed and latched into the Anti-Rotational Float Collar

The Top Plug is used as a follow-up plug to displace cement, latches into the upper end of the bottom plug after latching these provide an anti-rotational feature to eliminate rotation during drilling and save drill out time

### Performance Features

- The Non-Rotating Top & Bottom Cementing Plugs are designed to decrease drill out time
- No metal parts are used therefore the Plugs are PDC drillable

### Options

- The Non Rotating Cementing plugs are available in sizes 4 1/2" to 20"
- Options available in Non-Rotational Top Cementing Plug & Non-Rotational Bottom Cementing Plug as per requirement
- Wellsecure Non Rotating Cementing plugs are available in NR,SBR,NBR and HNBR grades.

CEMENT PLUGS



WELL SECURE





WELL SECURE



## **WELL SECURE OIL TOOLS PVT. LTD**

Plot No 6, Steet No 1, Bazri Industrial Area, Faridabad, Haryana India-121001

Phone: 0091-9667791040, 9667791041

Email: [info@wellsecureoiltools.com](mailto:info@wellsecureoiltools.com)



WELL SECURE

[www.wellsecureoiltools.com](http://www.wellsecureoiltools.com)